

ELECTRICAL SYMBOLS LEGEND	
	Fluorescent Light
	CHANDELIER
	Ceiling Fan w/ Light
	Ceiling Exhaust w/ Light
	Outdoor Motion Sensor Light
	Electric Meter
	Electric Panel
	Outdoor Wall Light
	Waterproof Recessed Ceiling Light
	Recessed Ceiling Light
	Ceiling Light
	Fluorescent Ceiling Light
	Smoke Alarm
	Carbon Monoxide Detector
	Wall Mount Duplex Receptacle
	Wall Mount Single Receptacle
	Ceiling Mount Garage Door Recept.
	240V Duplex Receptacle
	GFI Duplex Receptacle
	Waterproof Tamper Resistant Recept.
	Garbage Disposal Receptacle
	Dishwasher Receptacle
	Washing Machine Receptacle
	Single Pole Switch
	Three Way Switch
	Dimmer Switch
	Three Way Dimmer Switch

GENERAL ELECTRICAL NOTES

- 1 - All work to be done according to the latest edition of the California Electrical Code
- 2 - All receptacles are to be Tamper-Resistant
- 3 - All circuits are to be Arc-Fault Protected
- 4 - All outlets installed at 20" height from slab
- 5 - All circuits to the EP use 12 AWG copper wire
- 6 - All outlet circuits use 12 AWG copper wire
- 7 - All lighting circuits use 14 AWG copper wire

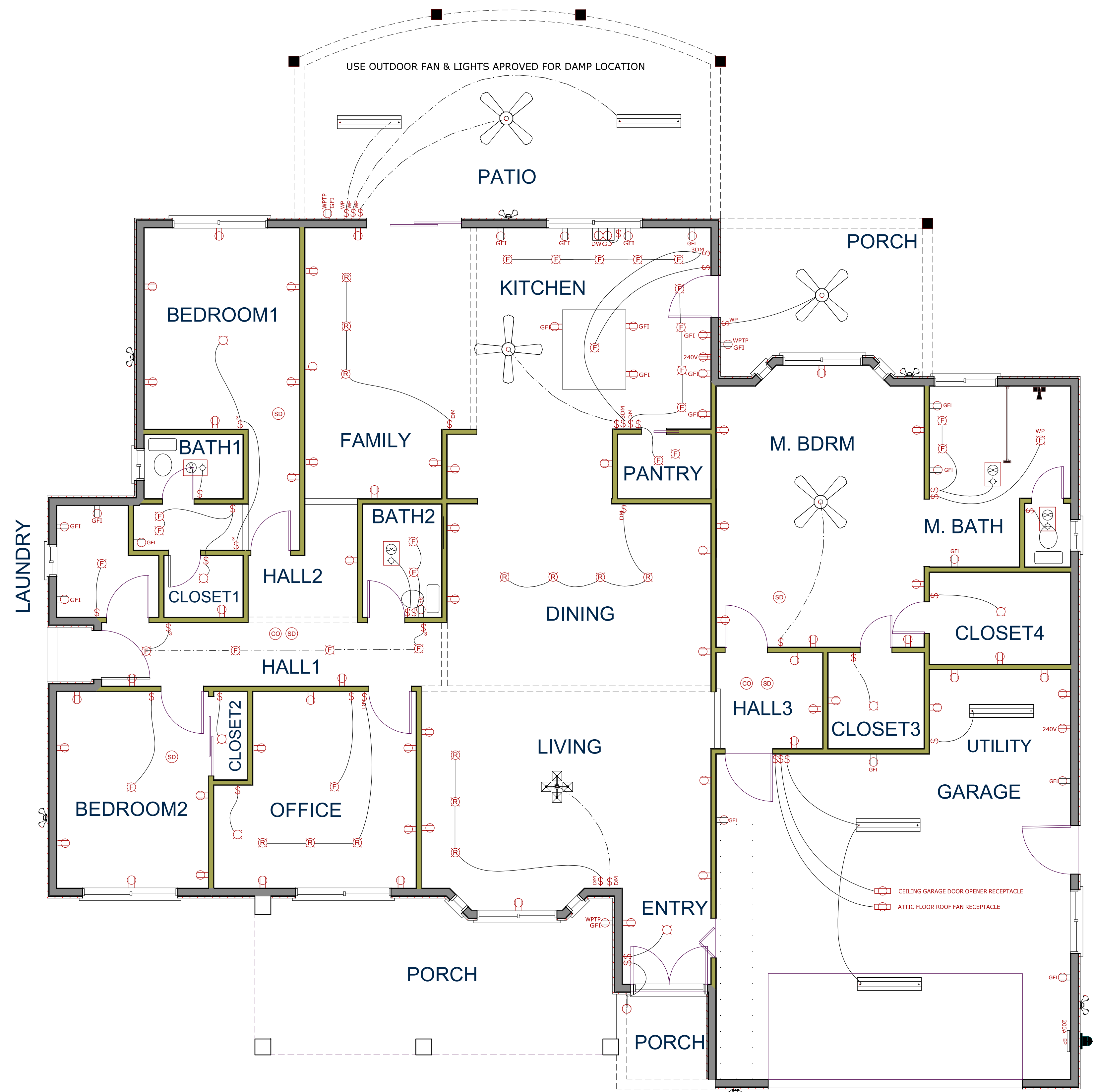

RECEPTACLES SCHEDULE				
#	Type	Count	Location	Notes
1	240V	1	Kitchen	Electr. Range
2	240V	1	Utility	--
3	GFI	3	Outdoor	--
4	GFI	10	Kitchen	--
5	GFI	2	Kitchen	GD, WM
6	GFI	3	Laundry	--
7	GFI	1	Bath1	--
8	GFI	1	Bath2	--
9	GFI	3	M. Bath	--
10	GFI	6	Garage	--
11	AFCI	5	Bdrms, Halls	Smoke Detect.
12	AFCI	7	Bedroom 1	--
13	AFCI	6	Bedroom 2	--
14	AFCI	6	Office	--
15	AFCI	8	M. Bedroom	--
16	AFCI	6	Living	--
17	AFCI	6	Family	--
18	AFCI	2	Hall 1	--
19	AFCI	1	Hall 2	--
20	AFCI	3	Hall 3	--
21	AFCI	6	Dining	--

SEPARATE RECEPTACLE CIRCUITS				
#	Circuits	Type	Current	Notes
1	1, 2	240V	20A	--
2	4	GFI	20A	Kitchen
3	5	GFI	20A	GD, WM
4	6	GFI	20A	Laundry
5	21	AFCI	20A	Dining

All other GFI/AFCI receptacles, max 10 per circuit

40 CIRCUITS 200 AMP PANEL

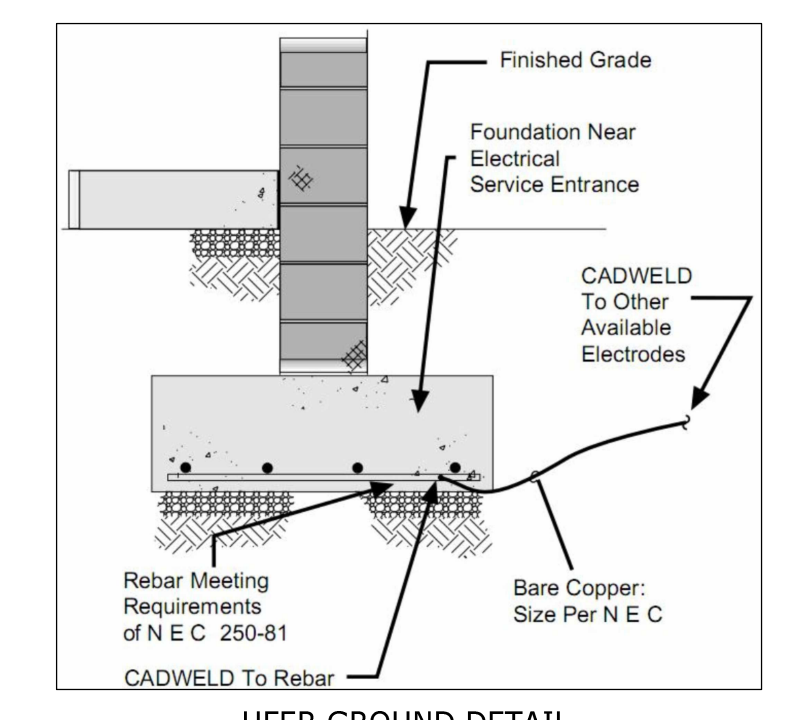
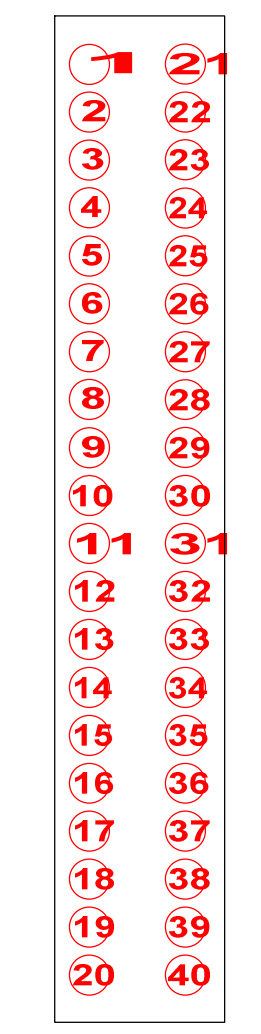

PROJECT:	BEFFA ADDITION/REMODELING
LOCATION:	20917 GREENLEAF DRIVE
TITLE:	ELECTRICAL PLAN
DATE:	JUN/30/2011
DRAWN BY:	MIHAI BEFFA
SHEET:	5 of 13
SCALE:	1/4" = 1'-0"

UNDERGROUND TO POLE